



219 E. MAIN STREET,
P.O. Box 546, ENNIS MT 59729
www.arrowreal.com
arrow@eralandmark.com
(406) 682-4290

LAND

**PROPERTY INFORMATION for the MADISON VALLEY,
including ENNIS, MCALLISTER, CAMERON, NORRIS, PONY and HARRISON, MT**

Lot #/Address: Lot 12, Slide Rock Road **Price:** \$99,900

Subdivision: Sportsman's Paradise, Wagon Track

Town: Cameron **Zip Code:** 59720 **County:** Madison

Terms: Cash; New financing

Residential: **Ranch:** **Commercial:** **Lot Size:** 20 Acres

Improvements to the Property: None **Public Land:** _____

Covenants/Restrictions: Yes **Zoning:** Residential **Taxes :** \$40..21 Year:2018

Water: **Public** **Private** **Well:** Depth: _____ GPM: _____ **Live Water:** _____

Water/Mineral Rights: _____ **HOA dues:** _____ **Sewage: Public** **Private**

Power: Available **Phone:** To Lot **Road:** Gravel **Fenced:** No

- Great recreational property near the National Forest at Mile Creek Trail head.
- Abundant wildlife and lots of opportunity for hunting and hiking.
- Close to Cliff and Wade Lakes, the Madison River and Quake Lake.
- Approximately 30 minutes to Yellowstone Park.
- Seasonal access. Power is less than 2 miles away.
- Perfect place to build your solar cabin and enjoy nature at its finest!
- All corners are pinned.
- Buy 12 & 13(borders Nat. Forest) for \$295,000. Or buy 11, 12 & 13 for \$365,000 and have it all!



NOTE: All information contained herein is gathered from a variety of sources deemed reliable, however, is not guaranteed or verified by the seller, ERA Landmark Arrow, or any of its associates. We urge independent verification of each and every item submitted to the satisfaction of a prospective purchaser.

SW MT MLS #: 300224 **DATE LISTED:** 6/5/17 **SELLER:** Pierce

Virtual Tour Link <http://www.itourmedia.com/display/index/388703>

Legal Description: Sportsman's Paradise – Wagon Track, Lot 12, Sec 23, T12 S, R02 E, W2NE4SE4

Google Earth Coordinates: Lat 44.773146 ° Lon -111.440873 ° **Elevation:** 6,969'

Listing Agent: Bowens **Cell:** 406-570-9233 Toni **Email:** toni@eralandmark.com
406 581-2991 Don arrow@3rivers.net

**RAYNOLDS
PASS
AREA**

SPORTSMAN'S
PARADISE B

SPORTSMAN'S
PARADISE A

PRIVATE RANCH

CONTINENTAL
DIVIDE RANCH

WAGONTRACK
RANCH

BUFFALO LANCE

NATIONAL FOREST

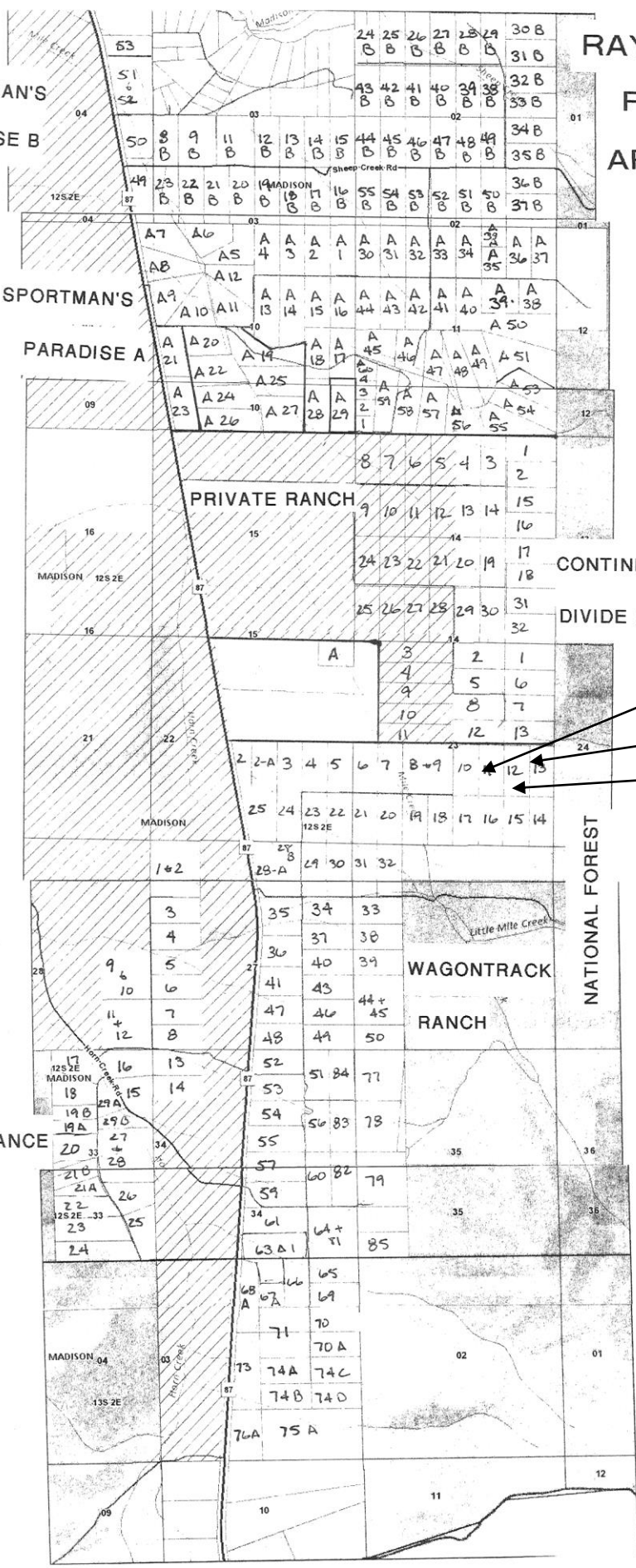

Lots 11, 12, 13
Slide Rock Road